

TRAC VAC

Model 1080

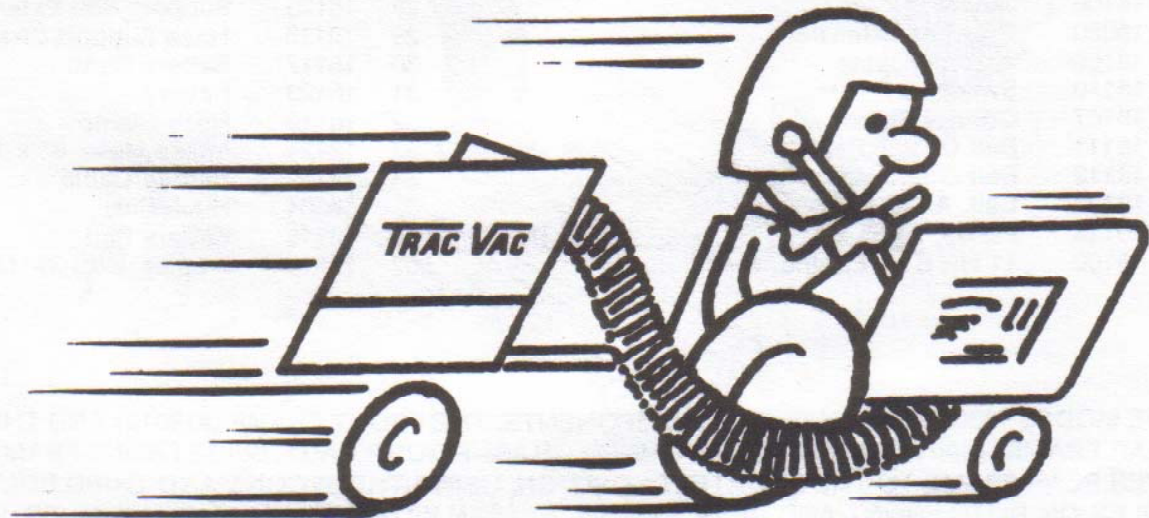

OPERATING AND ASSEMBLY MANUAL

PALMOR PRODUCTS, INC.

P.O. BOX 38 — THORNTOWN, INDIANA 46071 — 765-436-2496 FAX 765-436-2490

MODEL 1080 PARTS LIST

KEY	PART #	DESCRIPTION	KEY	PART #	DESCRIPTION
1	18012	Mainframe, RH	19	18131	Choke Cable
	18014	Mainframe, LH	20	88060	Latch Handle
2	18013	Subframe	21	88105	Latch Link
3	18030	Turbine Housing, RH	22	88104	Latch Pin
	18031	Turbine Housing, LH	23	88103	Latch Adjustment Screw
4	86040	Turbine	24	18120	Metal Hose Clamp
5	18050	Inlet	25	18040	Metal Exhaust Hose
6	85028	Bearing 1" Flange		18041	Metal Exhaust Hose, LH
7	85029	Bearing 1" Pillow Block	26	18070	Cart Connector
8	85027	Pulley, 1 VP44 x 1"	27	18071	Support Arm, RH
9	18109	Shaft, 1"		18072	Support Arm, LH
10	18106	Jack	28	18125	Support Arm Extension
11	18080	Drawbar Extension	29	18118	Hose Support Strap
12	18108	Throttle Cable	30	18117	Battery Strap
13	18110	Switch	31	18123	Battery
14	18107	Control Stand	32	18119	Hose Clamp
15	18111	Belt Guard, RH	33	18124	Intake Hose, 8" x 10'
	18112	Belt Guard, LH	34	18122	Battery Cable
16	18127	Belt, AX36	35	58104	Hitch Pin
17	18126	Pulley, AK56 x 1"	36	18116	Battery Pad
18	18100	11 HP B&S Engine	37	18114	Muffler, B&S 394170

THE MODEL 1080 FRAME HAS TWO COMPONENTS: THE FRONT FRAME (#18012) AND THE REAR FRAME (#18013). WHEN USING THE 360 OR 368-P DUMP CART, SLIDE FRONT FRAME OVER REAR FRAME TO THE SHORTEST POSITION. USING THE SECOND AND THIRD BOLT HOLES ON BOTH FRONT AND REAR FRAMES, FASTEN WITH 3/8" x 1" HHC AND NUTS. IF USING THE 368-X CART, USE THE FIRST AND THIRD BOLT HOLES ON BOTH THE FRONT AND REAR FRAMES. SECURE THE CENTER CHANNEL AS WELL.

1080 WIRING DIAGRAM

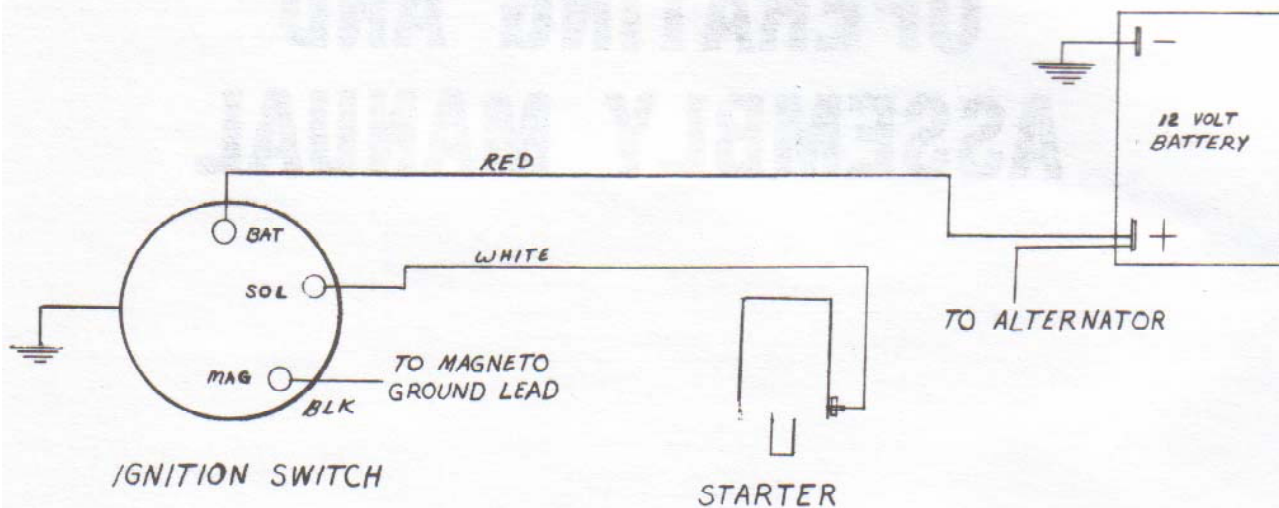

1080 PARTS DRAWING

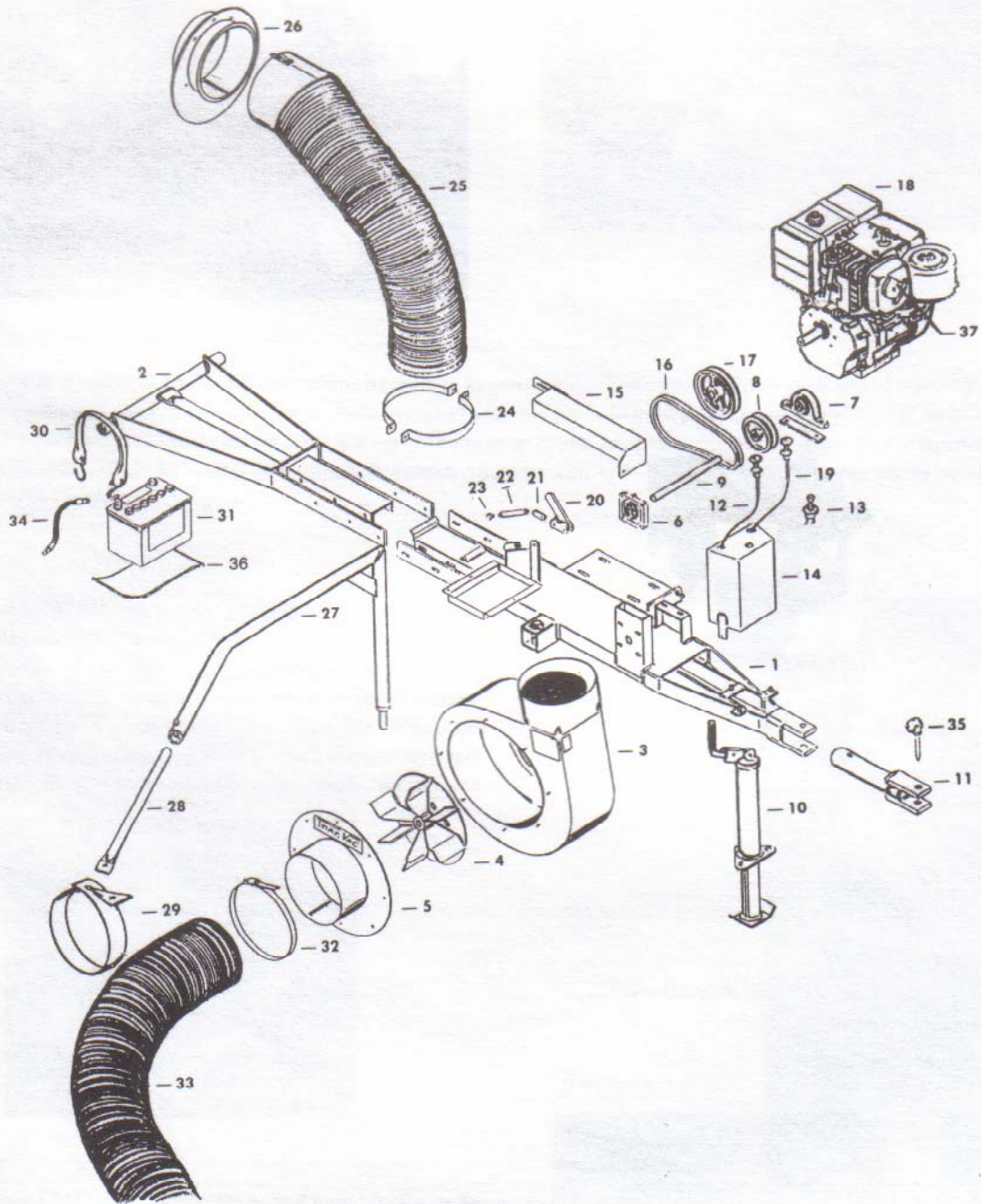

Service Information

- After 2 hours of operation check belt tension. Belts (16) should have 1/4" vertical slack halfway between pulleys. To adjust, remove belt guard, (13) loosen engine mounting bolts 1/2 turn. Loosen lock nuts on engine adjusting screws and move engine back by tightening inside screw first until proper belt tension is obtained. Be careful to maintain belt alignment. Tighten engine bolts and replace belt guard.
- Weekly service should include greasing jack shaft bearings (5), wheels, and support arm with gun grease; clean engine air filters, oil throttle and choke cables.

1080 PARTS DRAWING

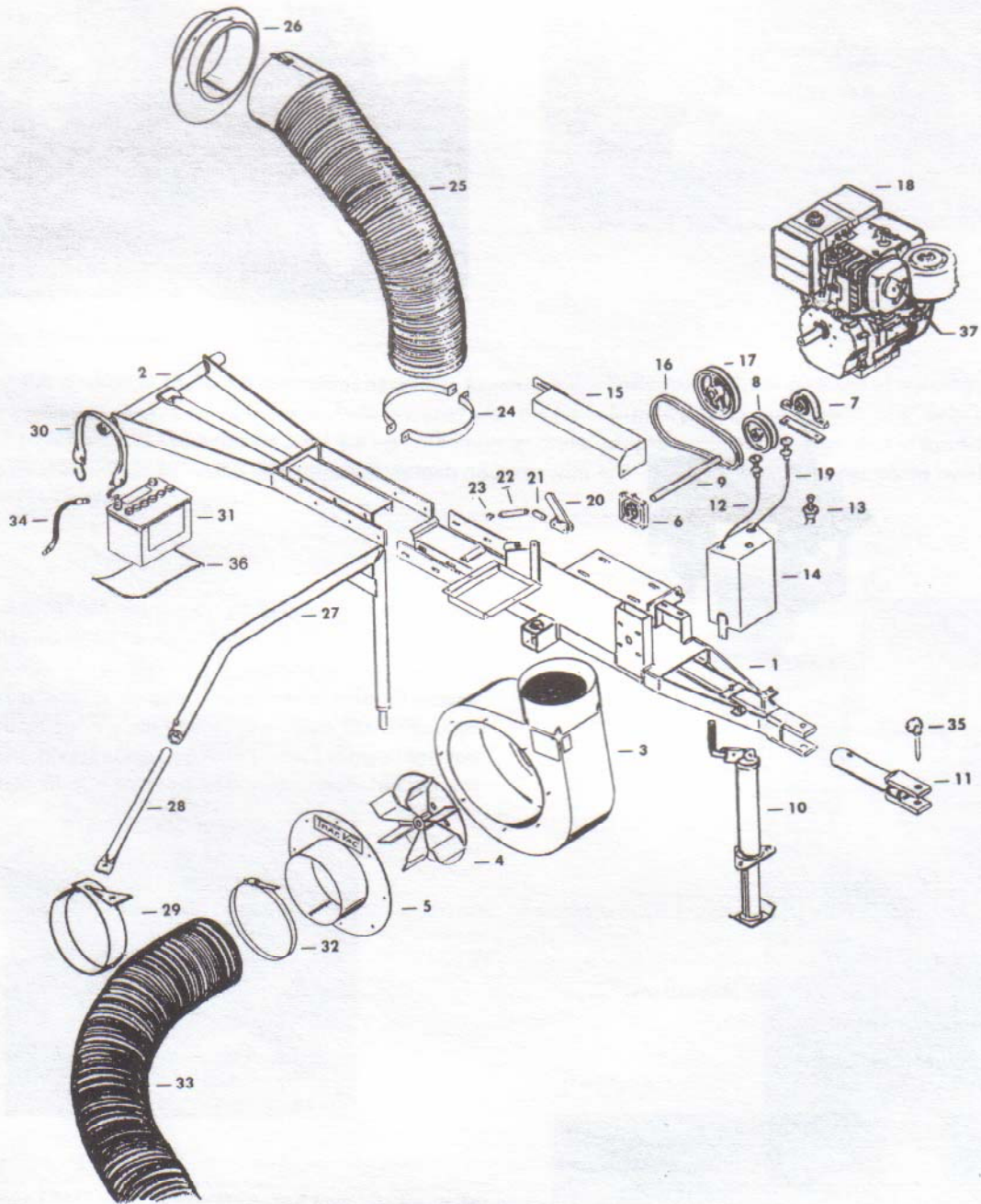

Service Information

- After 2 hours of operation check belt tension. Belts (16) should have 1/4" vertical slack halfway between pulleys. To adjust, remove belt guard, (13) loosen engine mounting bolts 1/2 turn. Loosen lock nuts on engine adjusting screws and move engine back by tightening inside screw first until proper belt tension is obtained. Be careful to maintain belt alignment. Tighten engine bolts and replace belt guard.
- Weekly service should include greasing jack shaft bearings (5), wheels, and support arm with gun grease; clean engine air filters, oil throttle and choke cables.

Place hose support arm into pivot point behind turbine housing. Put intake hose through support ring and attach to inlet of blower with clamp.



To mount the discharge chute it is sometimes necessary to remove the deflector shield or lift it out of the way. Place chute adapter on mower deck. Line up holes in chute adapter with the holes in mower deck. Attach with 1/4" bolts and lock nuts and tighten securely. If the holes do not line up with holes in chute adapter, place discharge chute in position on mower deck. Mark and drill 9/32" holes through deck. Attach adapter with 1/4" bolts. Attach discharge chute by lifting outside edge and locking lip in adapter.

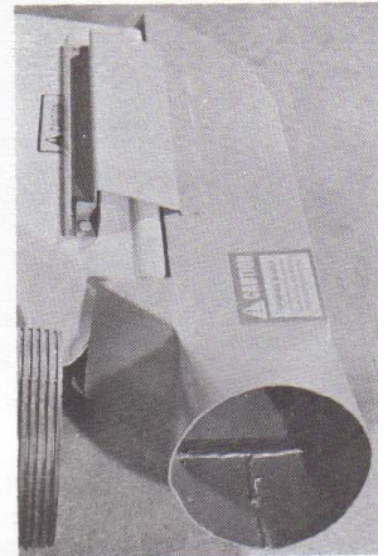
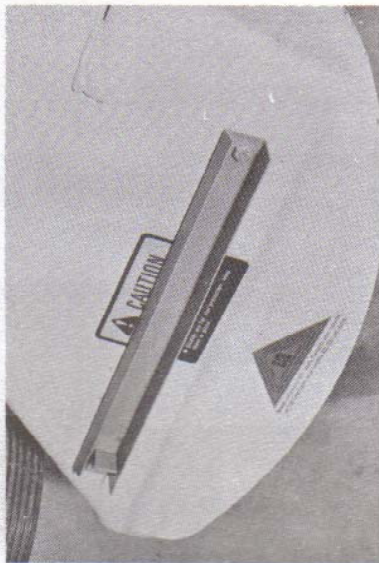

Attach your TRAC VAC to drawbar and turn tractor as far as possible to discharge side (right hand on most tractors). If wheel strikes turbine housing, unhook the 1080 from drawbar and install drawbar extension. (NOTE: Tractors with large rear wheels and three-point hitch should be connected to drawbar on three-point arms.

Reattach unit to tractor and turn tractor as far as possible in the opposite direction. Adjust hose support arm out until hose just clears rear wheel. If hose is not taut, remove from chute and cut off hose in three inch increments until hose is taut. When turned back toward the turbine housing, the hose should not drag the ground. If it does, extend the support arm.

Carefully fill the battery with acid.

Read engine operation instructions before using your TRAC VAC.

MODEL 280 CART COVER ASSEMBLY INSTRUCTIONS

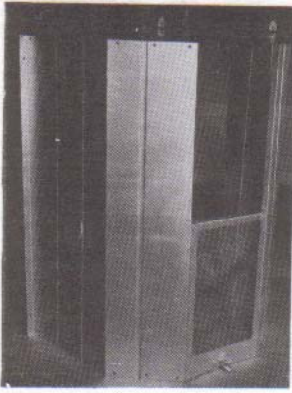

Place side panels on end with decal outward and about a foot apart at top.

Place screen on end between sides with latch outward and to the floor. Attach to sides with $\frac{1}{4}$ x $\frac{1}{2}$ bolts.

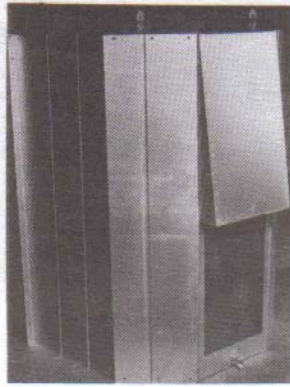

Place deflector on top of screen with screen to inside and holes in end up. Attach to sides with $\frac{1}{4}$ x $\frac{1}{2}$ bolts.



Place front on sides with flanges on the outside. Start corner bolts in sides and deflector before tightening.

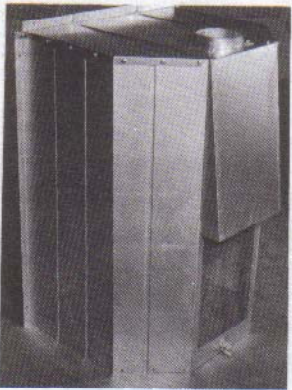

Place connector (packed with vacuum unit) in front and attach.



Place cover flat on floor and attach angles to sides at rear with leg of angle to rear of cover. Start corner bolts in sides before tightening. Attach cart to tractor. Place cover on cart and locate rear angles flush with rear of cart. Fit tailgate to cover using top latch and lower cart tailgate brackets only. Make certain tailgate fits flush against cover angles.

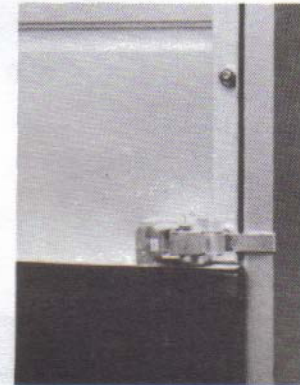

Place latch on each side of cart with tongue of latch to rear. Attach to side panel and cart.

Center front on cart and drill two $\frac{9}{32}$ " holes through each side flange of cart. Bolt front holes in sides of cart. Attach handles to tailgate on smooth side and install tailgate. (On JOHN DEERE cart, remove $\frac{3}{8}$ " bolt that attaches front, mark and drill through flange to replace bolt. On CASE cart, drill hole through cover and cart about 6 inches from rear of cart just ahead of stake pocket.)

OPERATING PROCEDURE

1. Follow engine manufacturers instructions in preparing engine for operation.
2. Inspect area to be vacuumed and pickup all harmful objects and litter.
3. For best vacuuming results operate tractor at manufacturers recommended speed for best cutting. If grass is high mow and vacuum the second time.
4. When mowing keep discharge chute to the outside of cutting area for better cut of grass and efficient pickup of grass clippings and leaves.
5. Your vacuum will operate best at full throttle. Under some conditions (1080 vac mounted on 48" mower) less than full throttle is necessary.
6. Do not overload cart. When cart is filled shut off vacuum engine, disconnect hose at snap disconnect, remove tail gate and dump.
7. When operating tractor on slope or grade exercise much caution. Do not cut across grade or slopes. Mow directly up or down hill.
8. Periodically tighten all bolts.
9. Listen for unusual vibration of engine or air turbine. If excessive vibration is present STOP engine and check for damaged blade.
10. Always shut off tractor engine and vacuum engine before servicing.
11. Replace deflector shield when discharge chute is removed.
12. When removing clogs SHUT OFF ALL ENGINES.

Warranty

The Manufacturer guarantees each new Trac Vac to be free from defects in workmanship and material and will replace, F.O.B. our factory, any defective parts within one year from purchase date, **90 day warranty for commercial use**, providing such parts are returned to the factory, transportation charges prepaid, and subject to our inspection. We will pay no bills for repairs made outside our factory unless authorized by us, and the above agreement shall not apply to any defects resulting from misuse, alterations, negligence, or accident. When defective parts are replaced free of charge it is agreed that the manufacturer is not liable for expenses covering labor, or any other expenditures that may be incurred in the replacement of defective parts. We reserve the right to incorporate changes in design without obligation to make these changes on units previously sold.

REV. 11/1991

PALMOR PRODUCTS, INC.

P.O. BOX 38 — THORNTOWN, INDIANA 46071 — 765-436-2496 FAX 765-436-2490