

ROTARY COMPOSTERS FROM TRAC VAC

A rich and endless vein of compost materials surrounds us. Compost is a mixture of leaves, grass clippings, garden and kitchen debris and the like.

In a working compost area, microorganisms break down the raw materials, or "cook" them. This heating process transforms the mixture into humus. Humus returns essential nutrients to the soil, promotes aeration and helps hold moisture and warmth. Compost enriches your garden, trees, flower beds, shrubs and even your lawn. Best of all, composting is an ecologically sound means of disposing of yard, garden and kitchen wastes: reducing volume by as much as 75%.

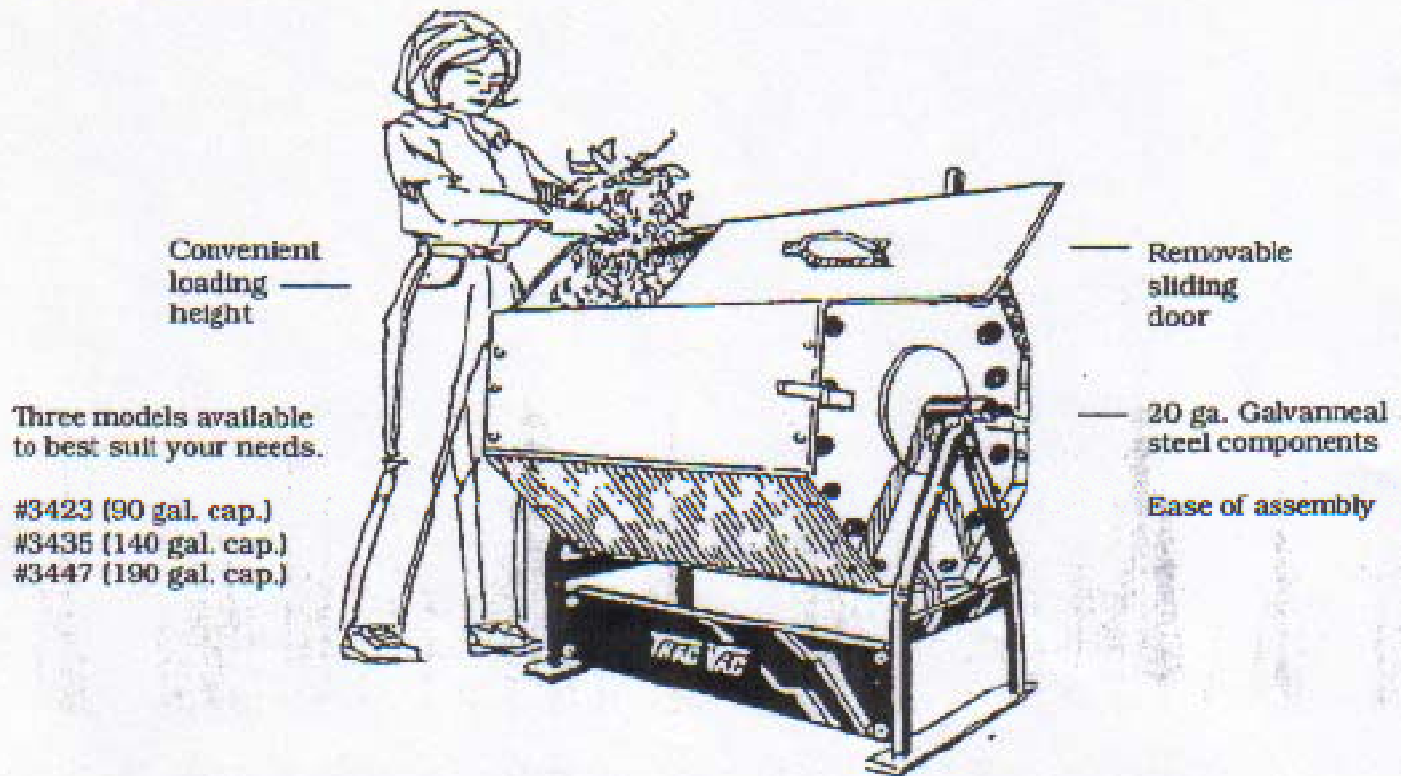

The ROTARY COMPOSTER from TRAC VAC will supply a continual source of compost so long as you regularly stake with the proper ingredients.

There are a number of "recipes" available for the best composting mixture of carbon and nitrogen sources. For your initial build, you might want to mix four parts of freshly cut grass clippings (for moisture and nitrogen content) and one part sawdust or dried shredded brush (for absorbency and a carbon source). You'll soon discover your own favorite "recipe".

Typical Carbon Sources: leaves; shredded newspapers; shredded brush; sawdust; weeds; garden debris.

Typical Nitrogen Sources: grass clippings; kitchen scraps (less meat and dairy products); manure (from plant-eating animals).

The Essentials of Heat, Moisture & Air

- Heating should be noticeable in the core within 24 to 36 hours. If heat buildup is too slow, add a nitrogen source.
- Moisture is a must. Dampen, if necessary. Ingredients should have the consistency of a wrung-out sponge. Turn your Composter once daily to ensure proper ventilation.

Compost should be ready within three to six weeks or sooner.

ROTARY COMPOSTER #3423(24" width)
 3435(36" width)
 3447(48" width)

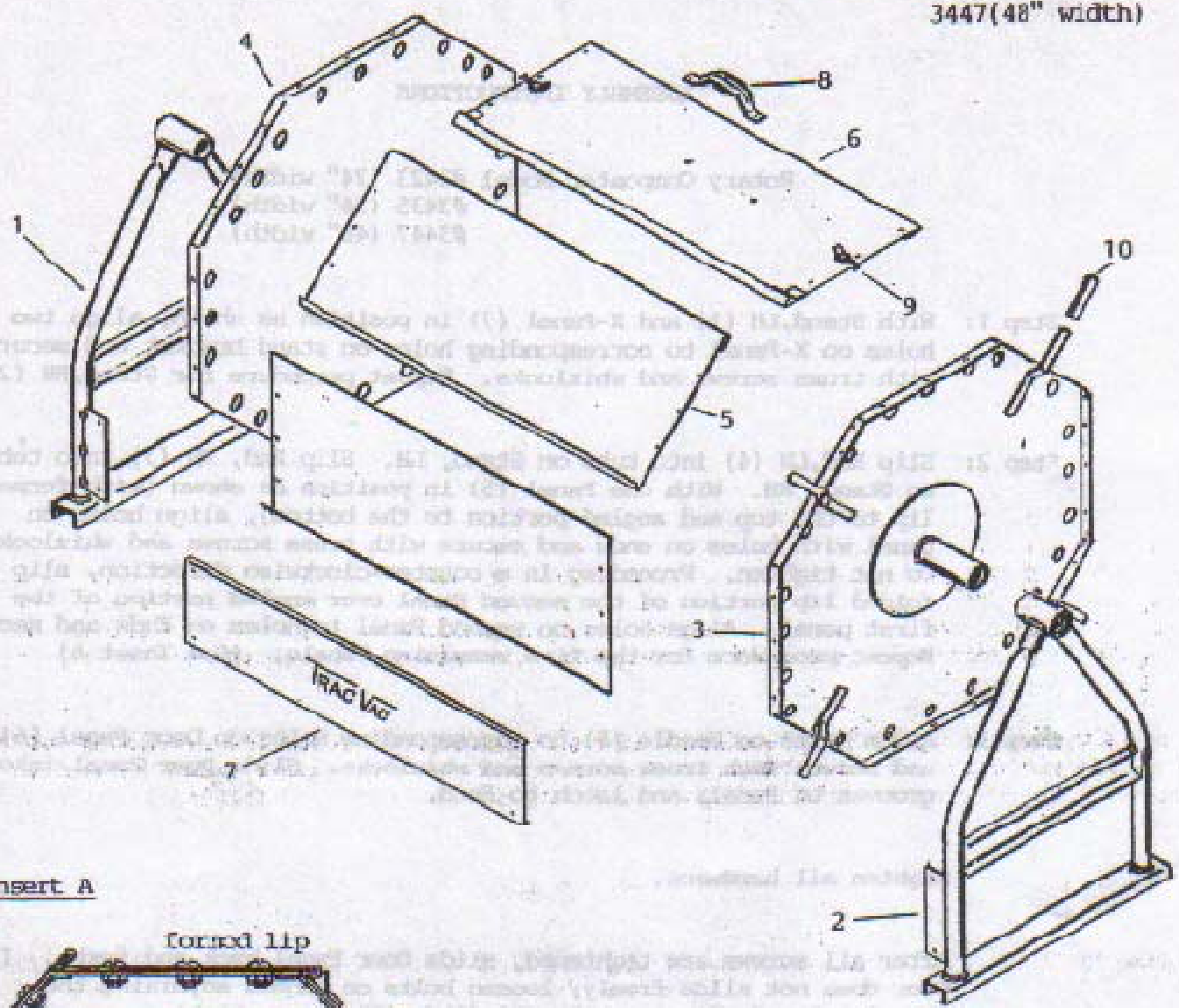

Insert A

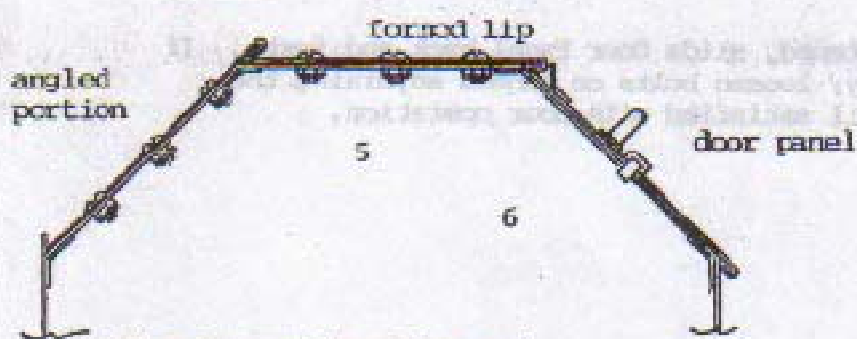

Start assembly at top and rotate counterclockwise.

KEY	PART#	DESCRIPTION
1	34242	Stand, LH
2	34243	Stand, RH
3	34211	End, RH
4	34212	End, LH
5	34231	Panel, 24"
	34365	Panel, 36"
	34471	Panel, 48"
6	34232	Door Panel, 24"
	34364	Door Panel, 36"
	34472	Door Panel, 48"
7	34248	X-Panel, 24"
	34368	X-Panel, 36"
	34488	X-Panel, 48"
8	28104	Handle
9	34249	Latch
10	34241	Handle Grip, Composter

ROBIN "RESEARCH" CORPORATION
 MODEL "D" LINE
 CHINA "BRITAIN"

ASSEMBLY INSTRUCTIONS

Rotary Composter Model #3423 (24" width)
 #3435 (36" width)
 #3447 (48" width)

Step 1: With Stand, LH (1) and X-Panel (7) in position as shown, align two holes on X-Panel to corresponding holes on stand bracket and secure with truss screws and whizlocks. Repeat procedure for Stand, RH (2).

Step 2: Slip End, LH (4) into tube on Stand, LH. Slip End, RH (3) into tube on Stand, RH. With one Panel (5) in position as shown (with formed lip to the top and angled portion to the bottom), align holes on panel with holes on ends and secure with truss screws and whizlocks. Do not tighten. Proceeding in a counter-clockwise direction, slip the folded lip portion of the second Panel over angled portion of the first panel. Align holes on second Panel to holes on Ends and secure. Repeat procedure for the five remaining Panels. (See Inset A)

Step 3: Align holes on Handle (8) to corresponding holes on Door Panel (6) and secure with truss screws and whizlocks. Slide Door Panel into grooves on Panels and latch to Ends.

Tighten all hardware.

After all screws are tightened, slide Door Panel back and forth. If Door does not slide freely, loosen bolts on Panels adjoining the Door Panel and adjust until satisfied with door operation.

REQUIREMENT	QTY	NO.
1/2" x 1/2" x 1/2" x 1/2"	2	1
1/2" x 1/2" x 1/2" x 1/2"	2	2
1/2" x 1/2" x 1/2" x 1/2"	1	3
1/2" x 1/2" x 1/2" x 1/2"	1	4
1/2" x 1/2" x 1/2" x 1/2"	2	5
3-92 1/2" x 1/2" x 1/2" x 1/2"	2	6
1/2" x 1/2" x 1/2" x 1/2"	1	7
1/2" x 1/2" x 1/2" x 1/2"	2	8
1/2" x 1/2" x 1/2" x 1/2"	2	9
1/2" x 1/2" x 1/2" x 1/2"	2	10

THIS IS AN INCOMPLETE LIST
 OF THE PARTS LISTED

Part #3410

Crank Assembly for Rotary Composter

<u>Key</u>	<u>Part#</u>	<u>Description</u>	<u>Qty.</u>
1	34101	Handle	1
2	34102	Mount Bracket	1
3	34103	35B12 Sprocket	1
4	34104	Sprocket Assembly	1
5	34105	Chain #35 x 48"	1
6	34106	U-Bolt	2
7		$\frac{1}{4}$ " x 1" Cotter Key	2
8		$\frac{3}{16}$ " x 1 $\frac{3}{4}$ " Sq. Key	1
9		$\frac{1}{8}$ " x 1" Cotter Key	1
10		$\frac{5}{16}$ " Whizlock	2
11	58106	Zerk 3/4" Machine Bushings	1 2

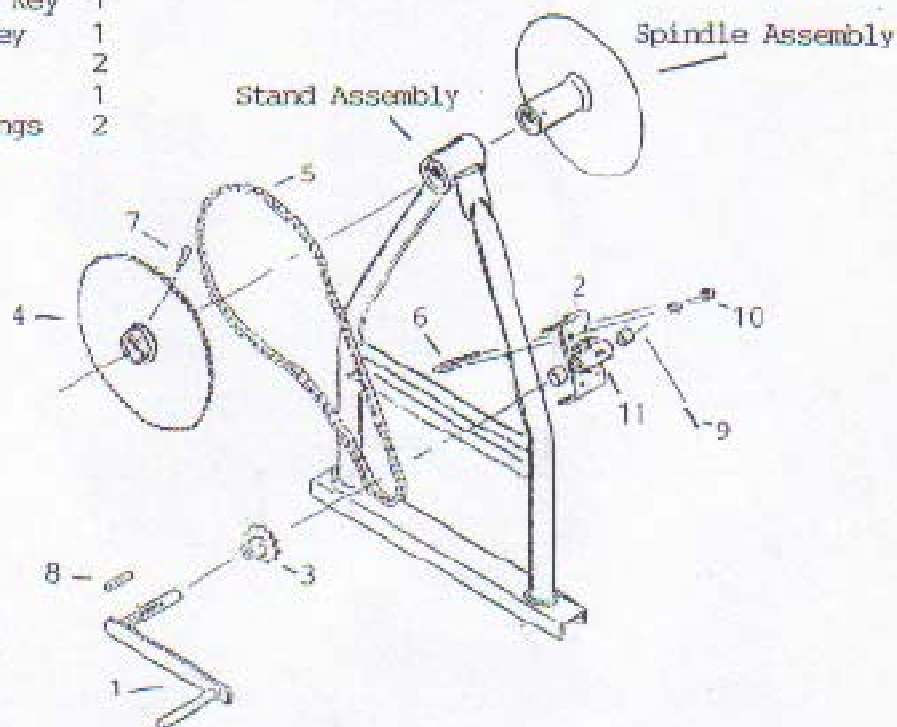

Assembly Instructions

The 3410 Crank Assembly can be mounted either to the left or right stand assembly (opposite the end with handles on drum) to all fully assembled TRAC VAC Rotary Composters. To assemble, slip Sprocket Assembly (4) over Spindle Assembly on Composter ends, trapping the Stand Assembly. Align holes on sprocket collar and secure with two $\frac{1}{4}$ " x 1" Cotter Keys (7). Slip $\frac{3}{16}$ " x 1 $\frac{3}{4}$ " Square Key (8) into groove on Handle (1). Slip 35B12 Sprocket (3) with teeth toward Handle, over shaft and Square Key. Slip shaft thru tube on Mount Bracket (2) over U-bolts (6) and secure assembly with $\frac{5}{16}$ " Whizlocks (10). Do not tighten. Slip chain over sprockets. Slide Mount Bracket down Stand Assembly leg to tighten chain. Align sprockets and tighten set screw on 35B12 Sprocket. Tighten U-bolts. Grease Zerk. NOTE: Chain must be tight and properly aligned.

revised 7/92